

NUMBER: 18-054-15

GROUP: Vehicle Performance

DATE: June 27, 2015

This bulletin is supplied as technical information only and is not an authorization for repair. No part of this publication may be reproduced, stored in a retrieval system, or transmitted, in any form or by any means, electronic, mechanical, photocopying, or otherwise, without written permission of FCA US LLC.

SUBJECT:

Mil Illumination: P2453,P2454,P2455 or P2463 Active or Stored

OVERVIEW:

This bulletin involves determining if the Differential Pressure Sensor and its Connector require repair.

MODELS:

2010-2015 (RT)

Chrysler Town And Country (International Only)

NOTE: This bulletin applies to vehicles equipped with the 2.8L Diesel Engine (Sales Code ENS).

SYMPTOM/CONDITION:

A small number of customers may experience a Malfunction Indicator Lamp (MIL) illumination. Upon further investigation the technician may find one or more of the following Diagnostic Trouble Codes (DTCs).

- P2453 - Diesel Particulate Filter Differential Pressure Sensor Circuit Performance
- P2454 - Diesel Particulate Filter Differential Pressure Sensor Circuit Low
- P2455 - Diesel Particulate Filter Differential Pressure Sensor Circuit High
- P2463 - Diesel Particulate Filter - Soot Accumulation

DIAGNOSIS:

Using a Scan Tool (wiTECH) with the appropriate Diagnostic Procedures available in TechCONNECT, verify all engine systems are functioning as designed. If DTCs or symptom conditions, other than the ones listed above are present, record the issues on the repair order and repair as necessary before proceeding further with this bulletin.

If the customer describes the symptom/condition listed above or if the technician finds the DTCs, perform the Repair Procedure.

PARTS REQUIRED:

Qty.	Part No.	Description
1	68080561AA	Wiring Kit
1	56044587AB	DPS Sensor

REPAIR PROCEDURE:

1. Disconnect the negative battery terminal.
2. Disconnect the Coolant Bottle and reposition it to reach the Differential Pressure Sensor (DPS) ([Fig. 1](#)).



Fig. 1 Differential Pressure Sensor Location - Engine Compartment Location

1 -Differential Pressure Sensor Location

3. Disconnect the differential pressure sensor harness connector and check for oxidation ([Fig. 2](#)).

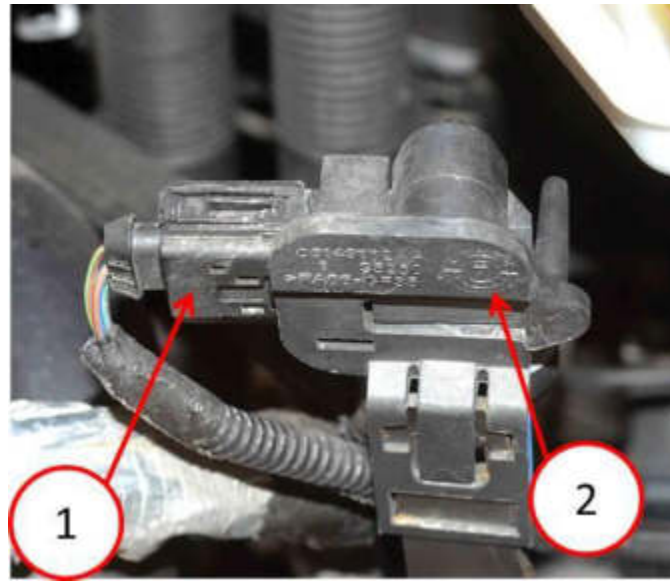

Fig. 2 Differential Pressure Sensor

- 1 - Differential Pressure Sensor Harness Connector
- 2 - Differential Pressure Sensor

-
4. Are the terminals oxidized/ corroded ?
 - a. Yes. >>> Proceed with [Step #5](#).
 - b. No. >>> This bulletin does not apply. Normal Diagnostics should be performed.

NOTE: Normal inspection methods may not uncover the type of corrosion present (fretting).

5. Disconnect the differential pressure sensor hoses.
6. Release the clips and remove the differential pressure sensor.
7. Using the Wiring Kit, P/N 68080561AA ([Fig. 3](#)), replace the existing 3 way connector and terminals with the new components from the kit which will be complete with silver plated terminals. To complete the Service Procedure only the white wires are necessary. Refer to the detailed service procedures available in DealerCONNECT> TechCONNECT under: Service Info>29- Non DTC- Diagnostic>Circuit Testing Procedures>Standard Procedure>Wire Splicing.

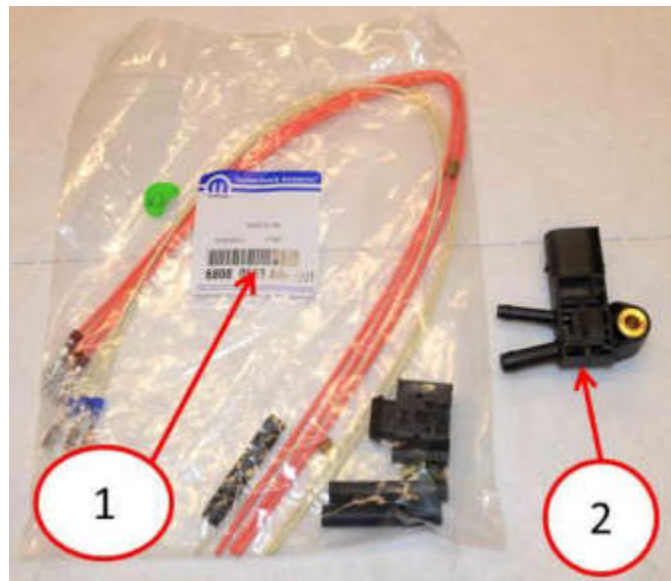

Fig. 3 Parts Required

- 1 - P/N 68080561AA - Wiring Kit
- 2 - P/N 56044587AB - Sensor

-
8. Replace the sensor and reinstall it.
 9. Reconnect the new differential pressure sensor hardness connector.
 10. Reconnect the differential pressure sensor hoses.



Fig. 4 New Differential Pressure Sensor Reinstalled

-
11. Reconnect the battery.

- 12. Any time the Exhaust Pressure Differential Sensor is replaced or the hose has been repaired, it is necessary to reset the offset value stored in the Powertrain Control Module (PCM). Using a Scan Tool (wiTECH) go to the PCM (Power Control Module) Misc. Functions and select the "Diesel Particulate Filter Replace" reset the values.
- 13. Clear the Stored DTCs.

POLICY:

Reimbursable within the provisions of the warranty.

TIME ALLOWANCE:

Labor Operation No:	Description	Skill Category	Amount
25-06-02-90	Sensor, Diesel Exhaust Pressure Differential - Replace w/ Electrical Connector and Terminals (2 - Skilled)	10 - Diesel	0.6 Hrs.

FAILURE CODE:

ZZ	Service Action
----	----------------